



Installation Guide

For Environment Sensor ZX-ES-J11W

Welcome!

This guide will walk you through the installation of the Environment Sensor.

Start enjoying your smart home experience today!

Content

In The Box	2
Appearance	3
Set up Environment Sensor	4

In The Box

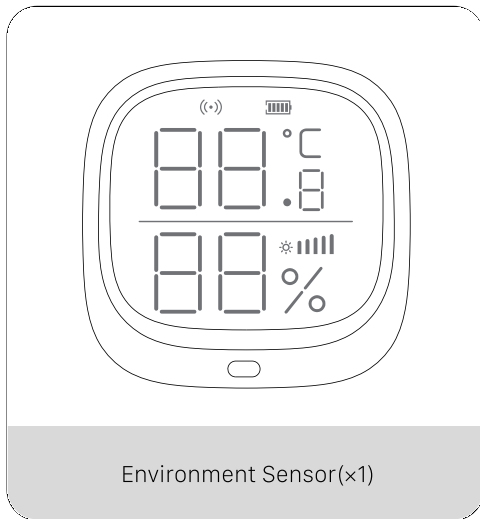

Appearance

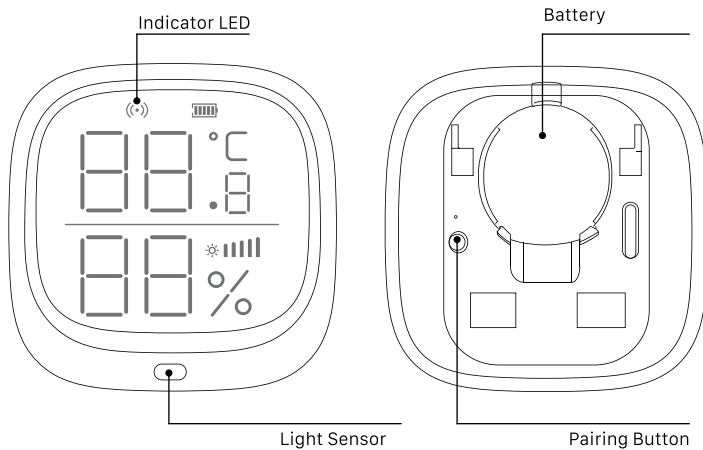

① Set up Environment Sensor

To control the Environment Sensor with a mobile device, install the Smart Life app. You can download the Smart Life app here.



② Add Environment Sensor

1. Launch the Smart Life app and follow the displayed instructions.
2. Add the gateway to the app according to the Multi-function Gateway Installation Guide.
3. Once the Multi-function Gateway is successfully added, click on "+" and select "Add Device".

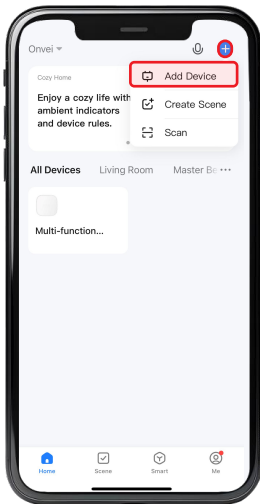

4. Navigate to the "Sensors" category and choose "Temperature and Humidity Sensor Zigbee".

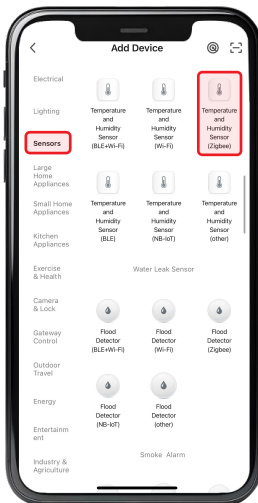

5. Select your gateway.

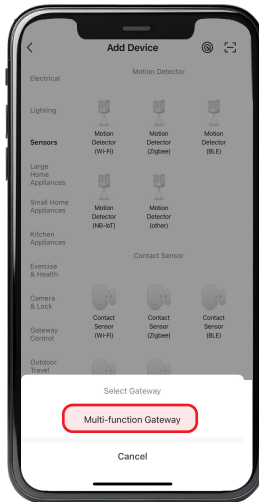

Note: The name of your gateway displayed in this section may differ from the name shown in this example image. It will display the name you have assigned to your device.

6. Select "Confirm the indicator is blinking" and click "Next".

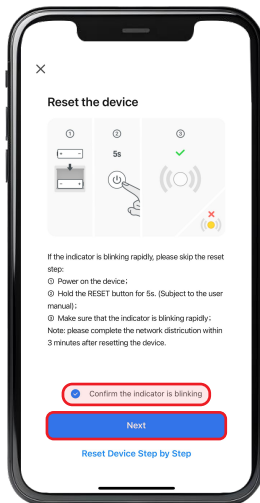

7. Open the back cover of the product, Remove the battery insulation strip. The LED on the display will start flashing rapidly, indicating that the device has automatically entered pairing mode.

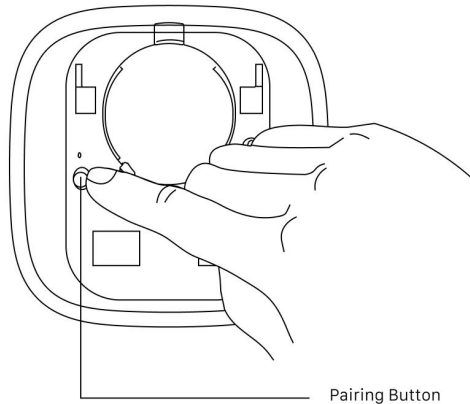

Note: Press and hold the button for 12 seconds to enter pairing mode. The LED will flash rapidly.

8. Wait for the app to detect and initialize the device.
9. After the device is detected and its name appears, click "Done".

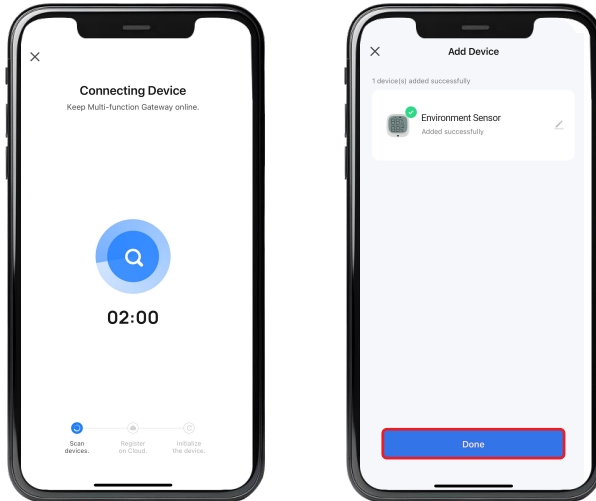

Note: Ensure you are within a suitable range of the device to establish a stable connection.

Congratulations!

Your Environment Sensor installation is complete.

Start Enjoying Your Smart Home Experience Today!

onvei.com